

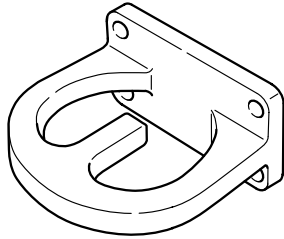

DODGE RAM

Tow Hooks



A 2x

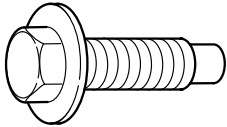

B 8x

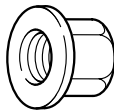

C 8x

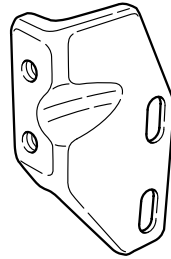

D

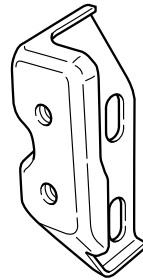

E

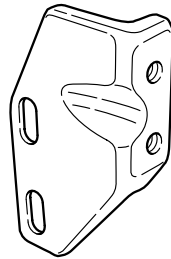

F

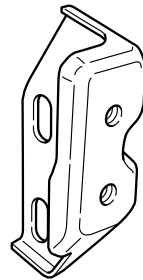

G

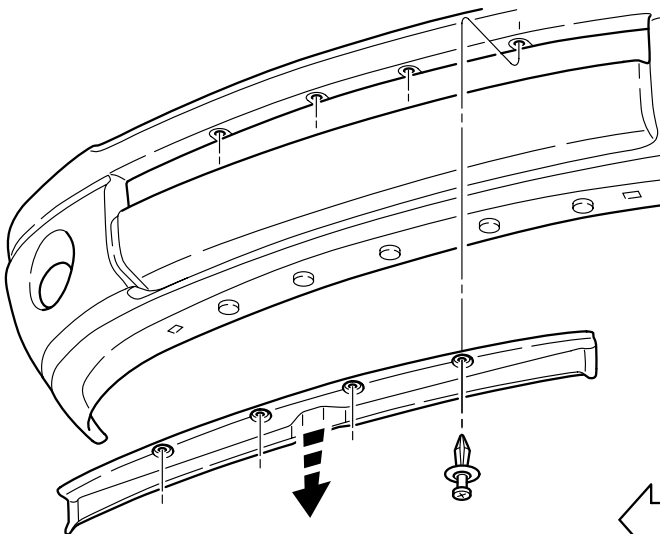
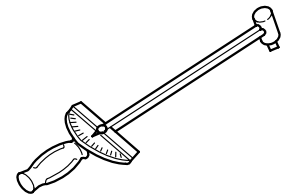
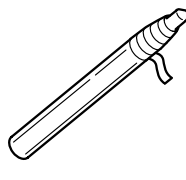
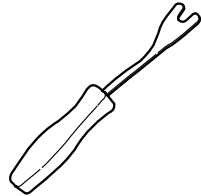
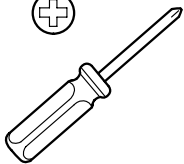

1A

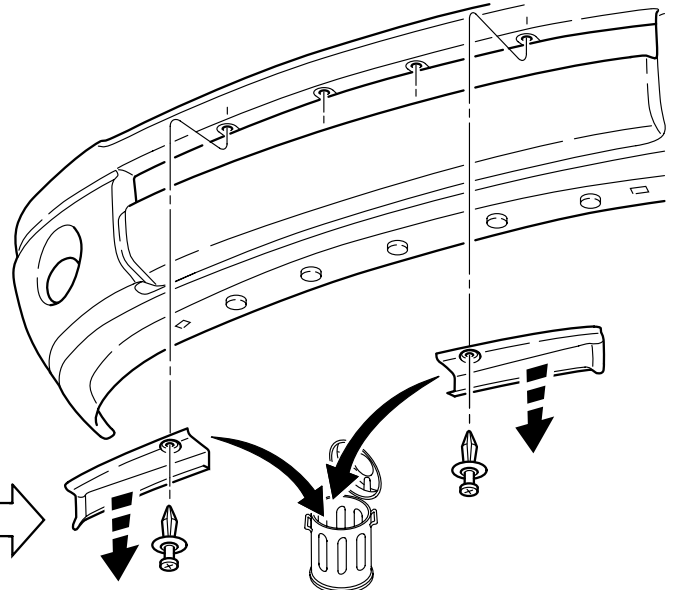

1B

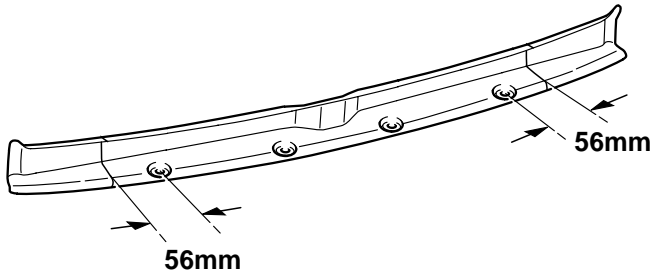
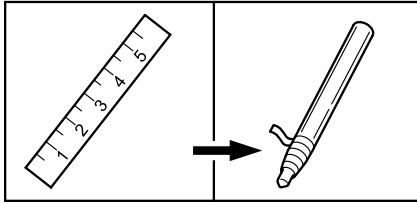

2

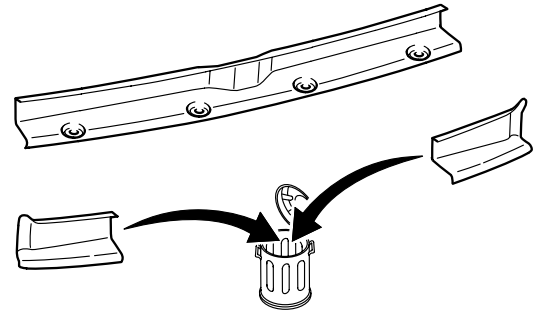
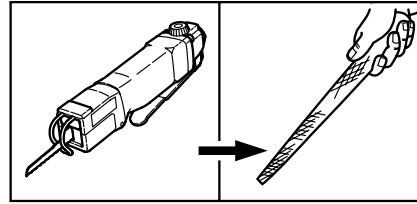

3

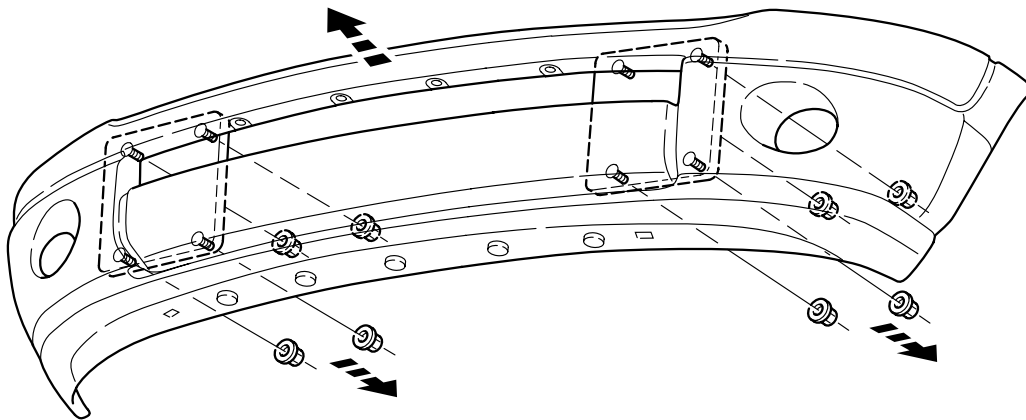

4

OPEN HOOD. RAISE AND SECURE VEHICLE ON A LIFT SO THAT HEADLAMPS ARE AT EYE LEVEL. DISCONNECT FOG LAMPS IF EQUIPPED.

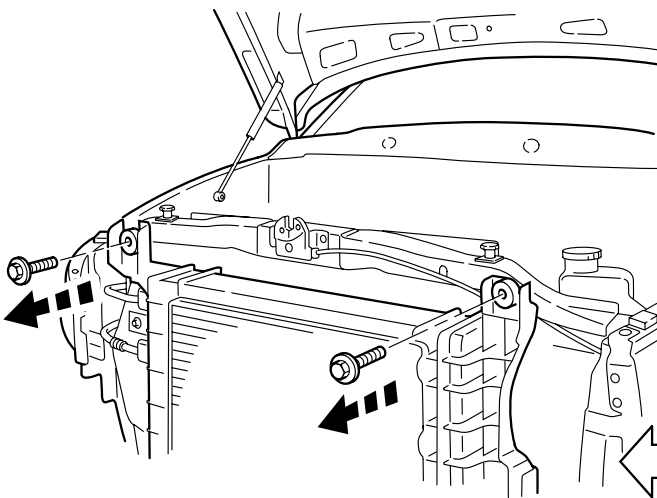

5A

V8 AND V10 GASOLINE

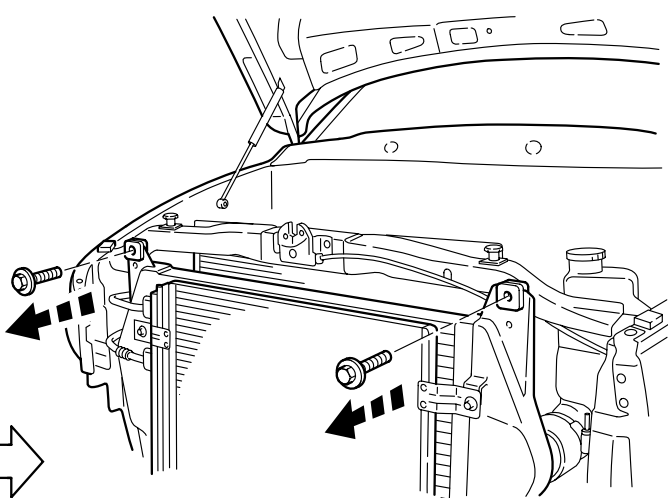

5B

DIESEL

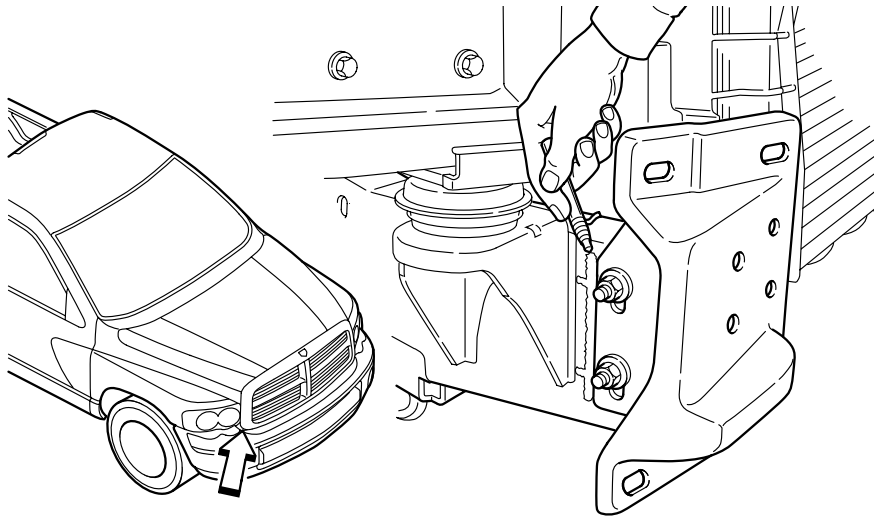

6 MARK THE SIDE RAIL AS SHOWN TO AIDE IN ALIGNMENT DURING FASCIA RE-INSTALLATION.

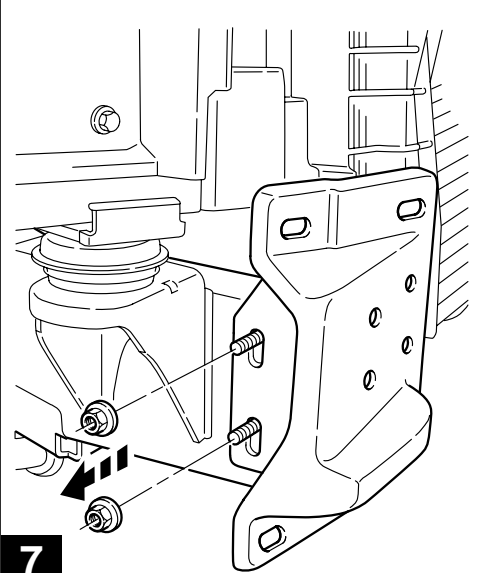

7

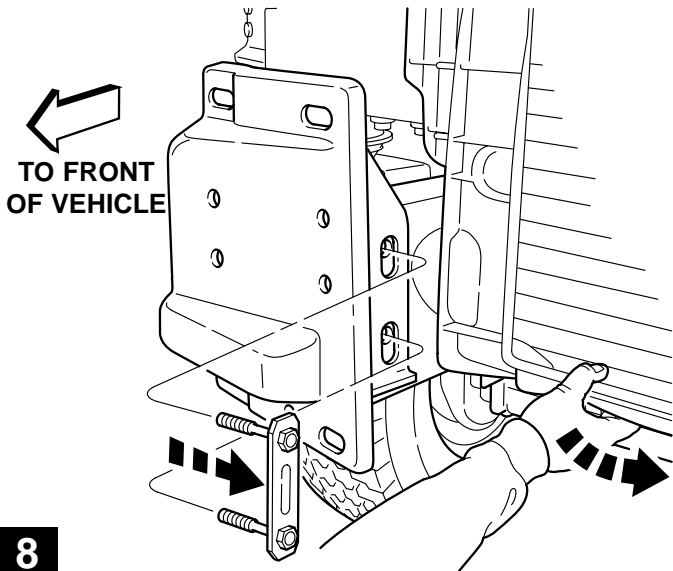

TO FRONT OF VEHICLE

8

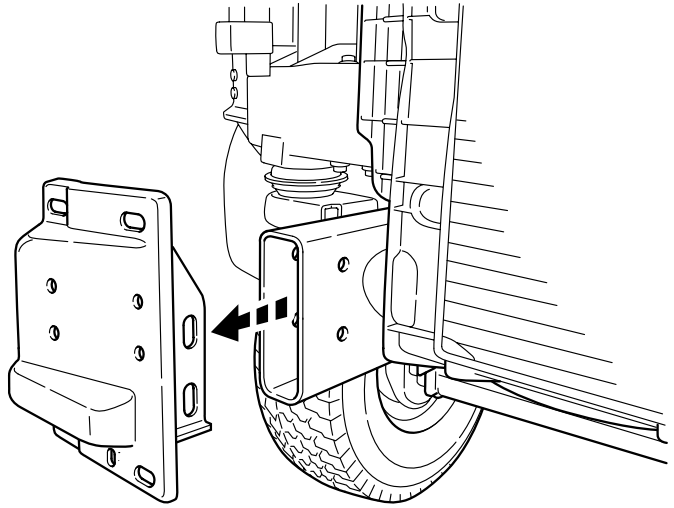

9 REPEAT STEPS 6-9 ON OTHER SIDE.

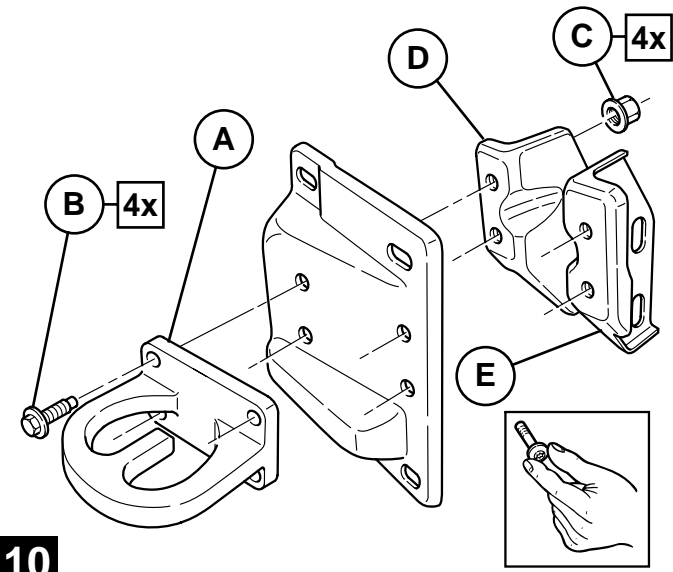

10

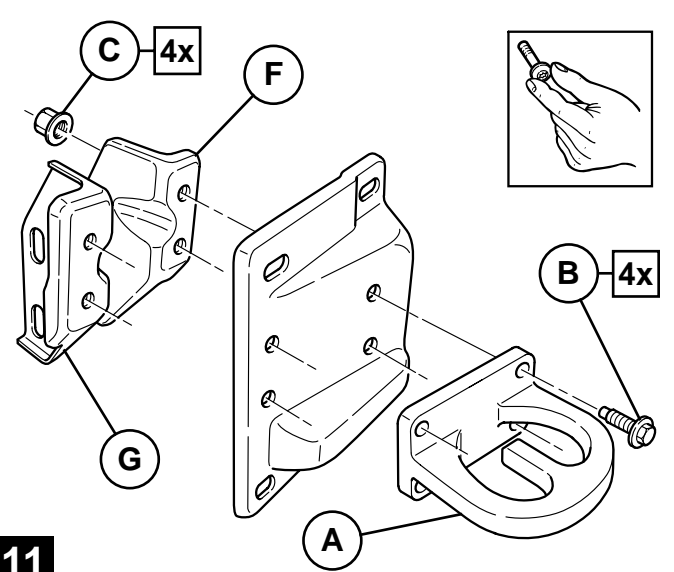

11

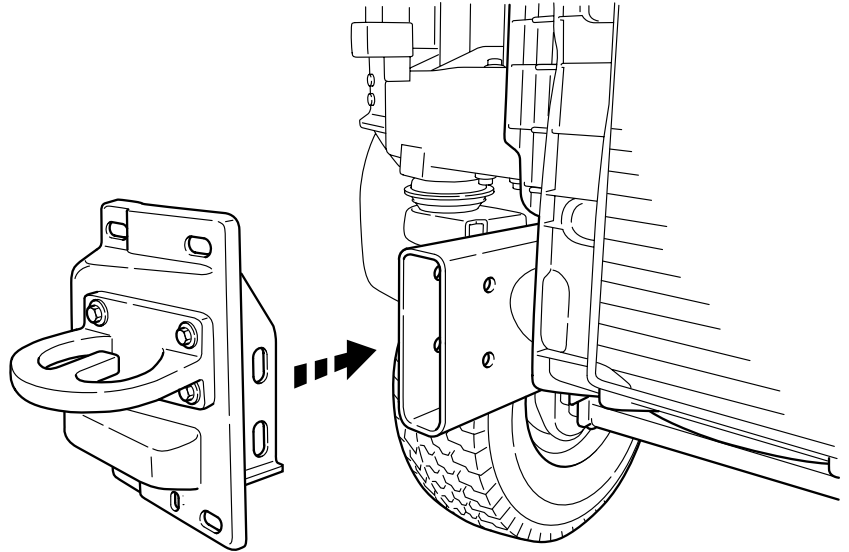
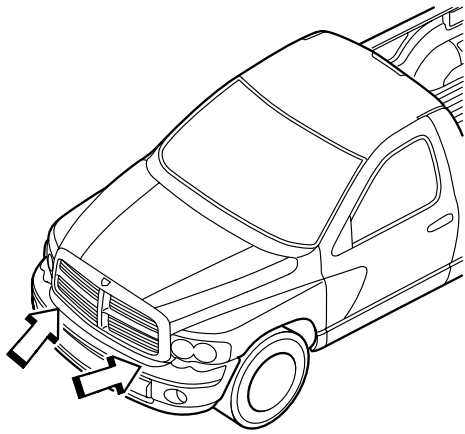

12

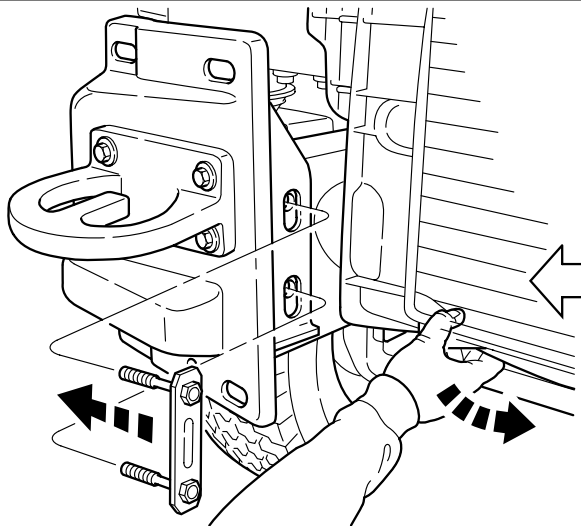

13A V8 AND V10 GASOLINE

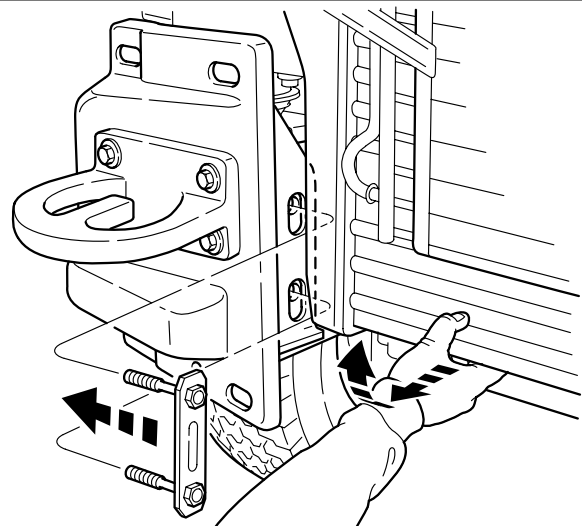

13B

DIESEL

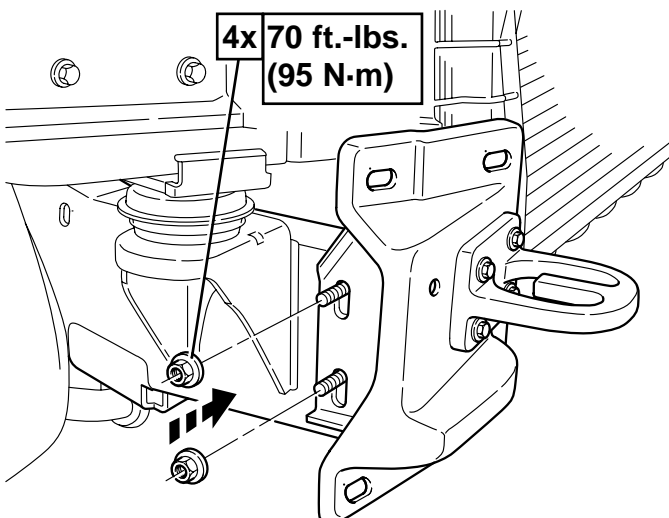

4x 70 ft.-lbs.
(95 N-m)

14

RE-ALIGN BUMPER BRACKETS AND TIGHTEN NUTS.

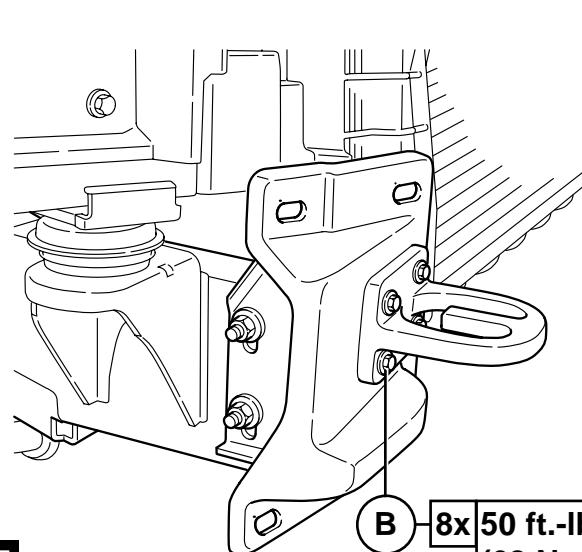

B 8x 50 ft.-lbs.
(68 N-m)

15

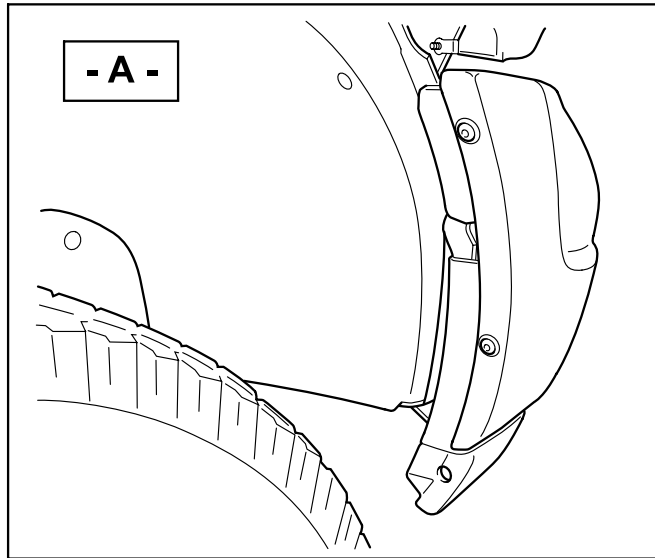
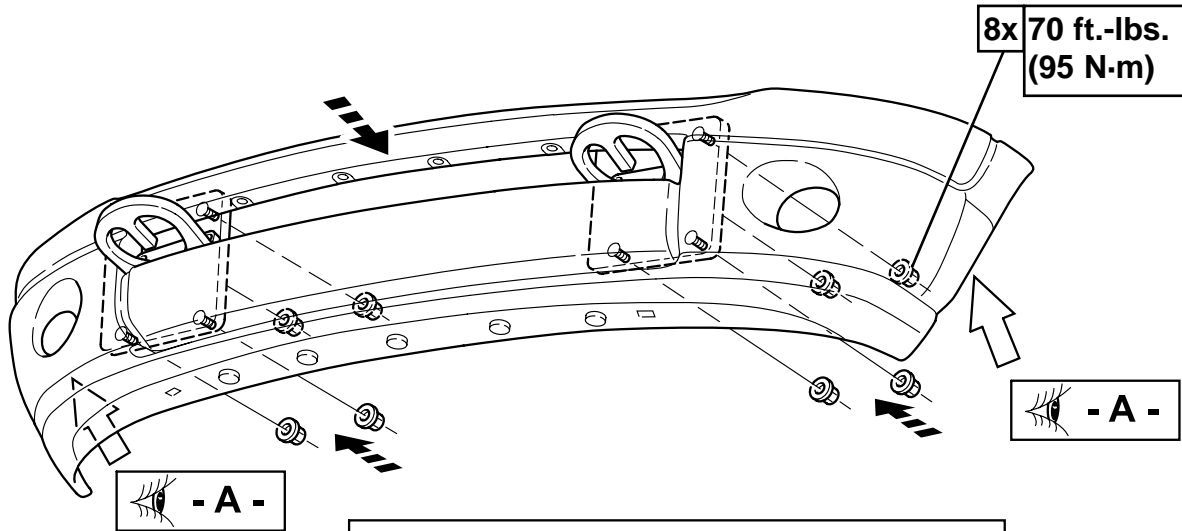

16 RE-ALIGN FASCIA TO VEHICLE AND TIGHTEN (8) NUTS. RE-CONNECT FOG LAMPS, IF EQUIPPED.

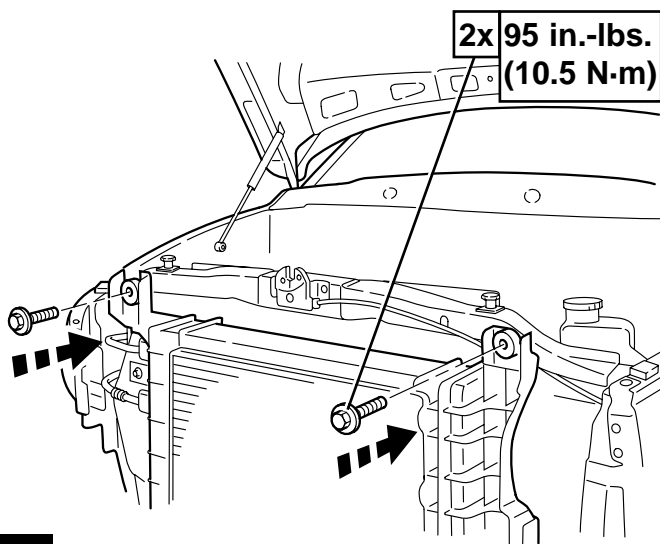

17

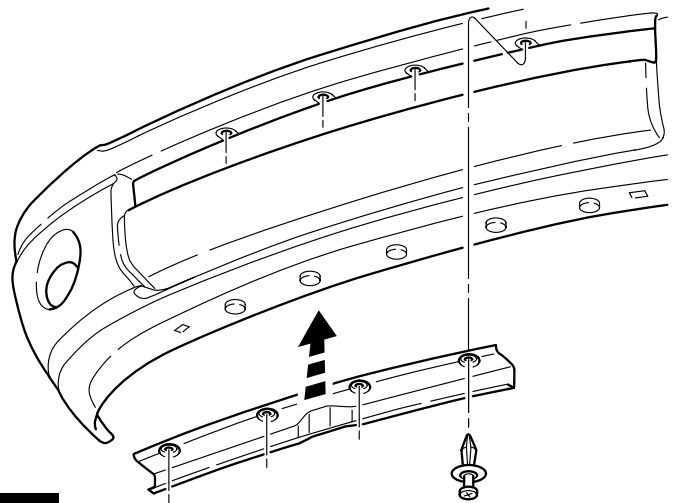

18