

FUEL RESERVOIR AND LEVEL UNIT DIESEL ENGINE D BODY - 1991-92-93
Figure 14-3025

90314 3025

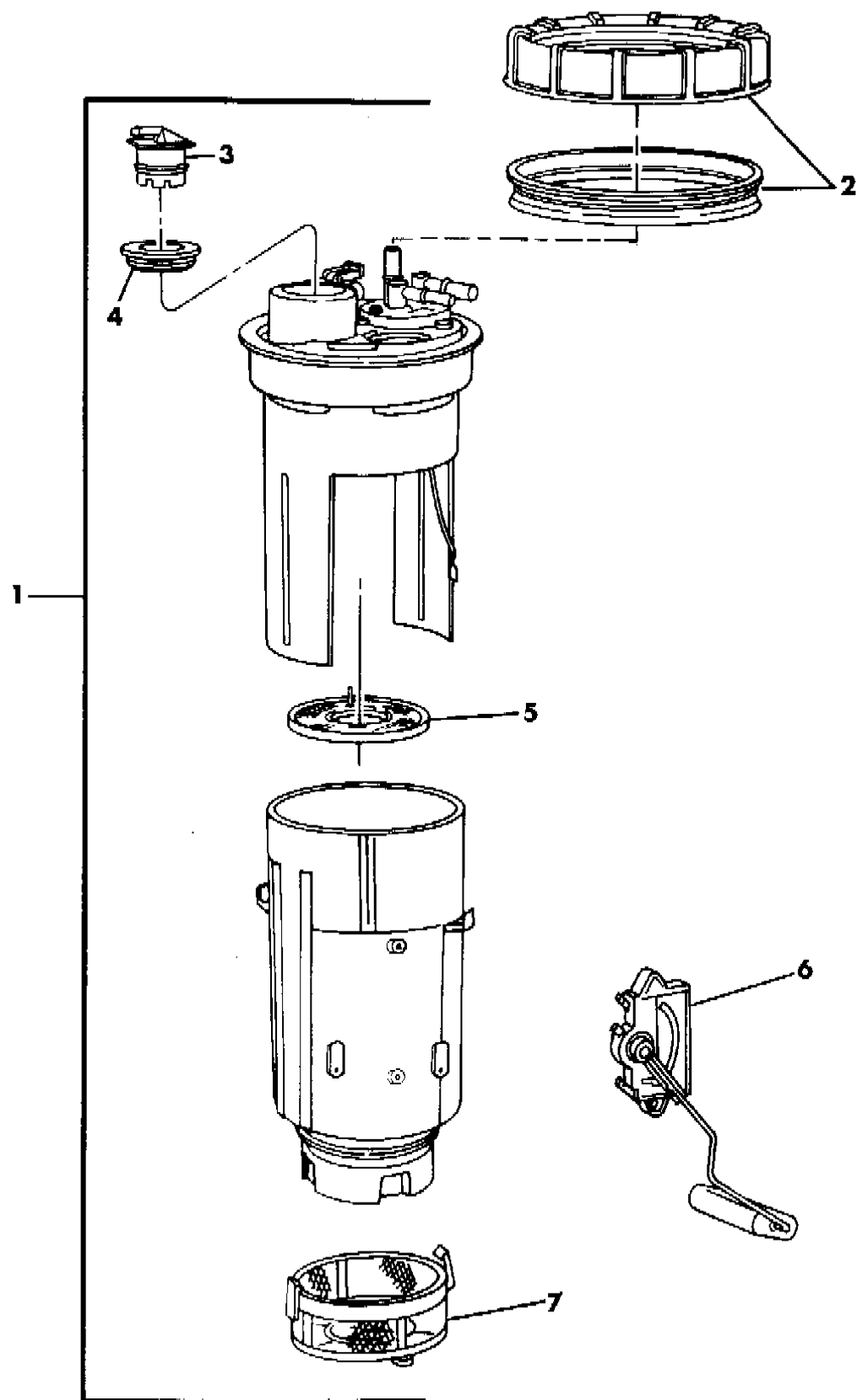

ITEM	PART NUMBER	QTY	BODY	MODEL	DESCRIPTION
1	5200 4838	1			RESERVOIR, LEVEL UNIT and PUMP, Fuel
2	5200 5389	1			NUT, Lock
-	5201 8808	1			SEAL, Fuel Module
3	4002 252	1			VALVE, Rollover
4	4002 149	1			GROMMET, Rollover Valve
5		1			FILTER, Fuel, Secondary, (Serviced in Assembly)
6	5200 4932	1			LEVEL UNIT, Fuel ***
7	5201 8425	1			FILTER, Primary

Item 1 is now part number 5201 8309

Item 6 is now part number 5201 7992

Item 7 is now part number 4864 307

MODEL CODES:

TRUCK LINE
 N1 = MID SIZE PICK-UP (4x2)
 N5 = MID SIZE PICK-UP (4x4)
 D1,2,3 = CONVENTIONAL TRUCK (4x2)
 D4 = SPORT UTILITY (4X2)
 D5,6,7 = CONVENTIONAL TRUCK (4x4)
 D8 = SPORT UTILITY (4x4)
 B1,2,3 = VANS AND WAGONS (4x2)
 T = FRONT SECTION (4X2)

BODY STYLE

WHEELBASE:	WAGONS	FRT SECT	CONVENTIONAL	SPORT UTILITY
VANS	(51) = 109" W.B.	(02) = 127" W.B.	(61) = 115" W.B.(D/W) (61) = 111.9" W.B.(N)	(71) = 106" W.B.
(11) = 109" W.B.	(52) = 127" W.B.	(04) = 145" W.B.	(62) = 131" W.B.(D/W) (62) = 123.9" W.B.(N)	CLUB CAB
(12) = 127" W.B.	(53) = 127X" W.B.	(05) = 163" W.B.	(63) = 135" W.B.	(31) = D1
(13) = 127X" W.B.			(64) = 159" W.B.	(32) = D1,D2,D5,D6
			(31) = 130,9" W.B.	

AR = Use as Required - = Non Illustrated Part P.A.R. = Paint as Required