

- (1) Disconnect the speed sensor pigtail harness from the main engine wiring harness near the front/top of engine.
- (2) Remove the clip bolts from the sensor pigtail wiring harness.
- (3) Remove the two speed sensor mounting nuts (Fig. 8).
- (4) Remove the speed sensor and its two mounting spacers from the vehicle.

INSTALLATION/ADJUSTMENT

The engine speed sensor uses a slotted hole on one side (Fig. 9) to adjust its depth. A brass (non-magnetic) feeler gauge must be used to adjust the sensor,

Sensor-to-vibration damper air gap is: 1.25 MM (.049 in.) minimum to 1.30 MM (.051 in.) maximum.

- (2) Position speed sensor, its two mounting spacers and two mounting nuts to the engine. Install mounting nuts finger tight.
- (3) Route sensor wiring harness behind engine pulleys. Install and tighten wiring harness clip bolts.
- (4) Place the feeler gauge between the sensor and the vibration dampener.
- (5) Gently seat (push down) the sensor until it contacts the feeler gauge. **Be sure the sensor is not near either of the notches (Fig. 8) on the vibration damper. If sensor is adjusted at or near these notches, it will be damaged when engine is started.**
- (6) Tighten sensor mounting nuts to 24 N•m (18 ft. lbs.) torque.
- (7) Remove feeler gauge.
- (8) Connect the sensor electrical connector to the main engine wiring harness.

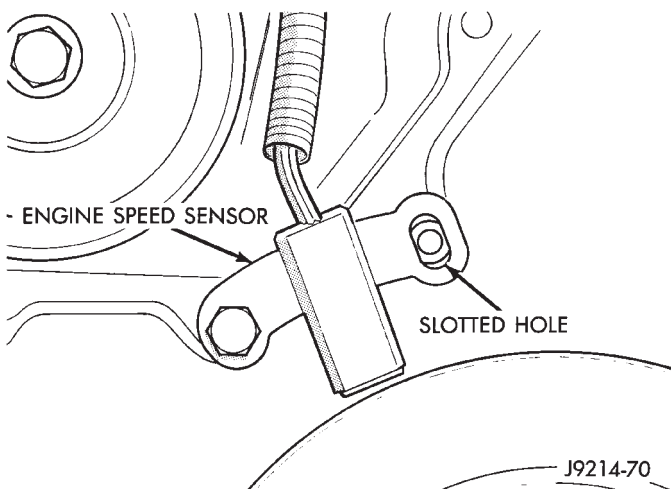

Fig. 9 Engine Speed Sensor—Installation

FUEL DRAIN MANIFOLD

REMOVAL

- (1) Remove the fuel drain manifold holddown clamp mounting screws (Fig. 10).
- (2) Remove injection pump vent capscrew (Fig. 10).

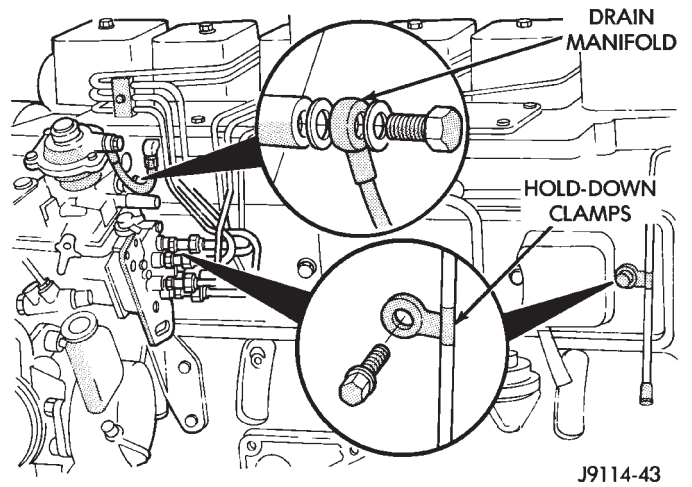

Fig. 10 Fuel Drain Manifold

- (3) Remove fuel drain manifold fitting screws and washers at each fuel injector (Fig. 11).

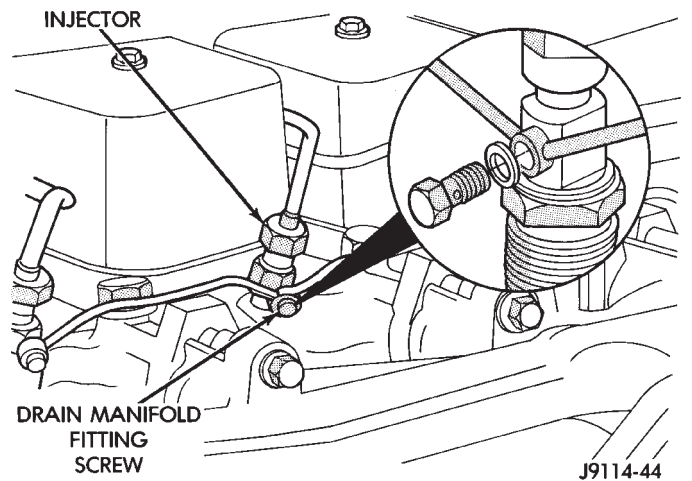

Fig. 11 Fuel Drain Fitting Screws

- (4) Disconnect drain line T-fittings.

INSTALLATION

- (1) Using new seals on all fittings, assemble fuel drain manifold in reverse order of disassembly.
- (2) Tighten drain manifold fitting screws at the injectors to 8 N•m (6 ft. lbs.) torque.
- (3) Tighten drain manifold holddown clamp screws to 24 N•m (18 ft. lbs.) torque.
- (4) Tighten injection pump capscrew to 32 N•m (24 ft. lbs.) torque.

FUEL HEATER

The fuel heater is located above the fuel/water separator filter (Fig. 12).

REMOVAL

- (1) Thoroughly clean the area around the separator filter before service is performed.
- (2) Disconnect the Water-in-Fuel sensor electrical connector (Fig. 12).